

PHASE III AREA- WEST OF 5TH AVE
& NORTH OF TH 40 & WEST OF TH 75

PHASE II AREA- BETWEEN 5TH AVE
& 1ST AVE

PHASE I AREA- EAST OF FIRST AVENUE

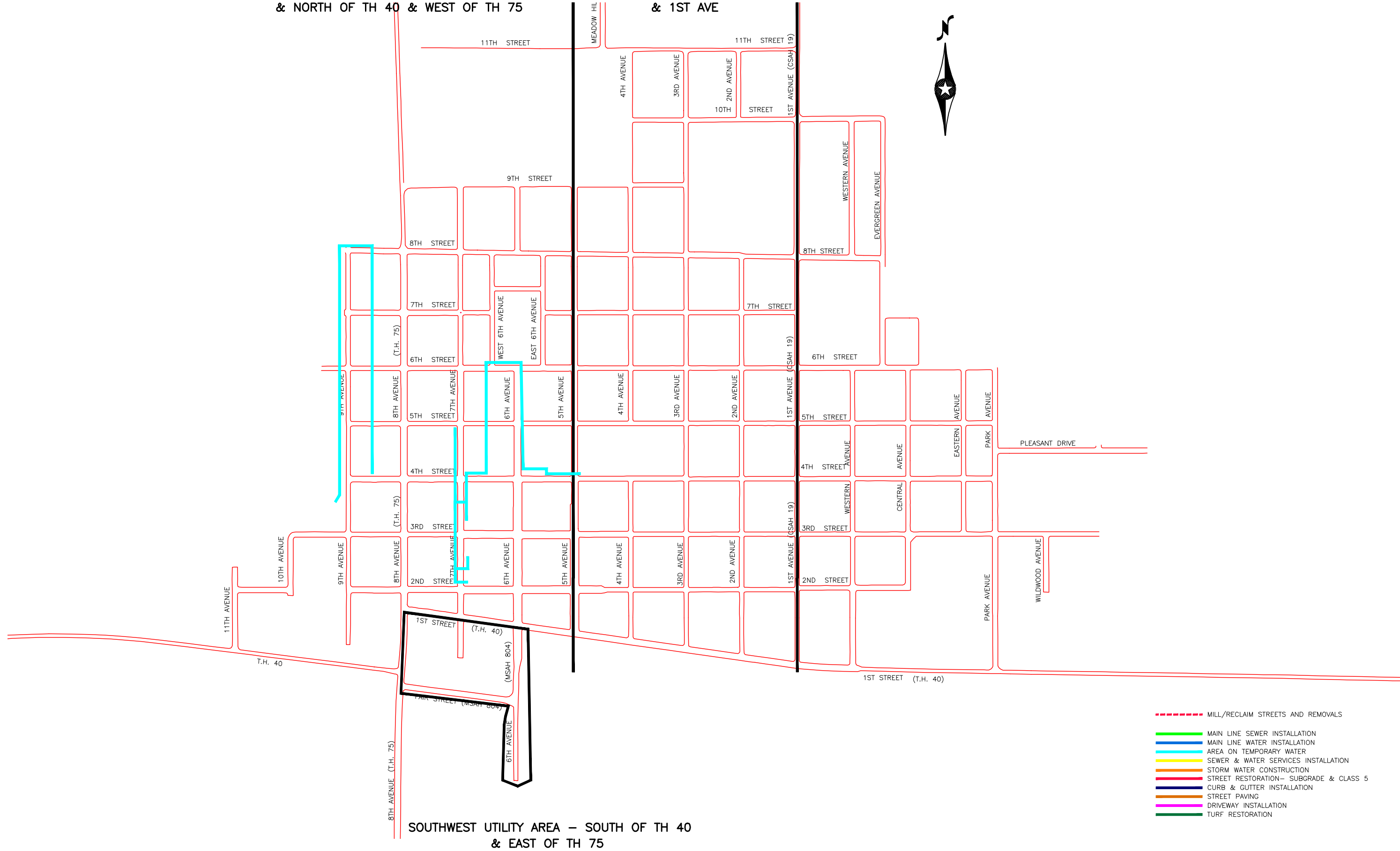

- MILL/RECLAIM STREETS AND REMOVALS
- MAIN LINE SEWER INSTALLATION
- MAIN LINE WATER INSTALLATION
- AREA ON TEMPORARY WATER
- SEWER & WATER SERVICES INSTALLATION
- STORM WATER CONSTRUCTION
- STREET RESTORATION- SUBGRADE & CLASS 5
- CURB & GUTTER INSTALLATION
- STREET PAVING
- DRIVEWAY INSTALLATION
- TURF RESTORATION

SOUTHWEST UTILITY AREA - SOUTH OF TH 40
& EAST OF TH 75

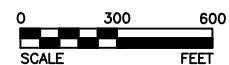

BOLTON & MENK, INC.
Consulting Engineers & Surveyors
MANKATO, MN FAIRMONT, MN SLEEPY EYE, MN WILLMAR, MN
BURNSVILLE, MN CHASKA, MN RAMSEY, MN AMES, IA

CITY OF MADISON, MN
PROJECT UPDATE MAP- WEEK OF APRIL 19, 2010
LOCATION OF TEMPORARY WATER

FIG 1

©Bolton & Menk, Inc. 2007. All Rights Reserved
H:\MAD\W1339881\Project Update\Cad\39881-TEMPWTRMAP.dwg 4/21/10 8:19 am