

Laurel Court Transit Hub

Construction Phasing Options

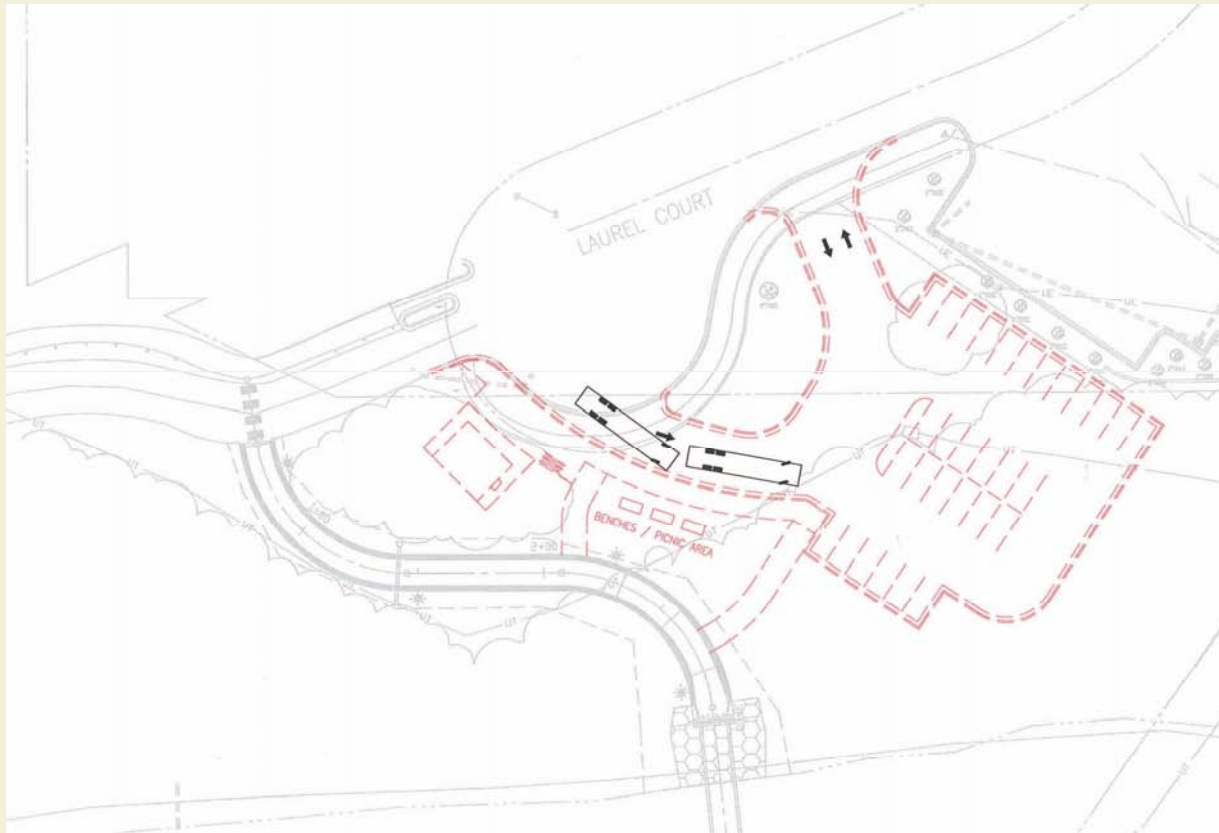

Option A – Parking Lot

- 30 stalls
- Portable facilities

Option B – Parking Lot and Shelter

- 30 stalls
- Portable facilities
- Transit shelter

Option C – Transit Hub

- 30 stalls
- Transit structure as shown

Estimated Costs \$180k to \$300k