

Mississippi Drive | Corridor Revitalization



A Destination Transportation Project...



**Muscatine
Power and Water**
Your reliable neighbor



**CANADIAN
PACIFIC**



Welcome!

Tonight's Agenda:

- Review progress to date
- Discuss upcoming schedule and tasks
- Present developed design concepts
- Collect feedback on preferred design alternatives
- **Answer YOUR Questions**

Overview | Corridor Revitalization

Project Process: *Where are we?*

- Visioning
- Info Gathering and Outreach
- Preliminary Design November-June
- Final Design June-September 2016
- Bid Document Preparation September-December 2016
- Bid Letting February 2017
- Construction Spring 2017

Mississippi Drive | Corridor Revitalization

Your Project Team



Let's Get Started

What best describes your involvement tonight?

- A. Business Owner
- B. Work Here (but don't live here)
- C. Active Resident
- D. Visitor (not from Muscatine)

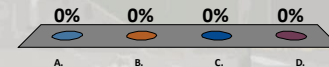

Overview | Scope of Work

Corridor Map:

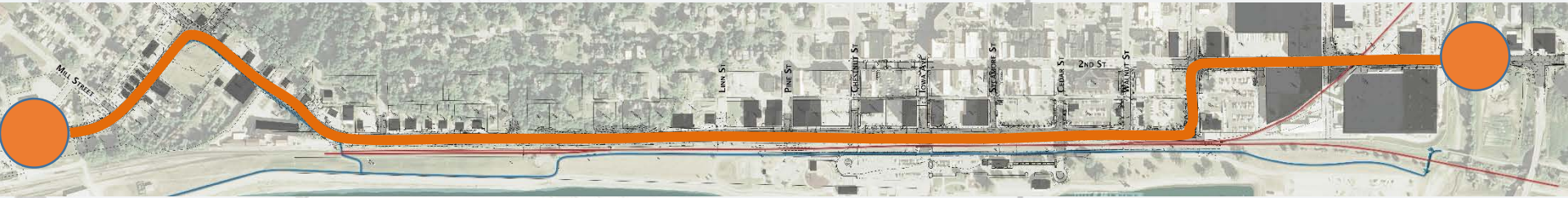

Project Extents:

- Main Street & Grandview Ave to E 2nd Street, thru HNI Campus
- Within current Right-Of-Way
- Will make connections/transitions North/South as needed

Overview | **Scope of Work**

What are the project elements?...recap

- Financial Partnership between the City, Canadian Pacific Railroad and MPW
- The elevation of the railroad and Miss. Dr. has been raised already and will be leveled
- The final product will be designed to handle the existing and future traffic demands, including trucks
- The design will be sensitive to our climate, be cost conscious and consider long-term maintenance

The Big Picture | Project Goals

Project Goals:

- Modernize Mississippi Drive
- Incorporate Complete Streets Design Principles
- Provide a Safe and Attractive Environment for All Users
- Improve Connectivity to the Riverfront
- Enhance Overall Aesthetic of the Corridor
- Effectively Engage the Public Throughout the Process
- **Implement a Community Supported and Technically Sound Project**



The Big Picture | Dissecting the Corridor

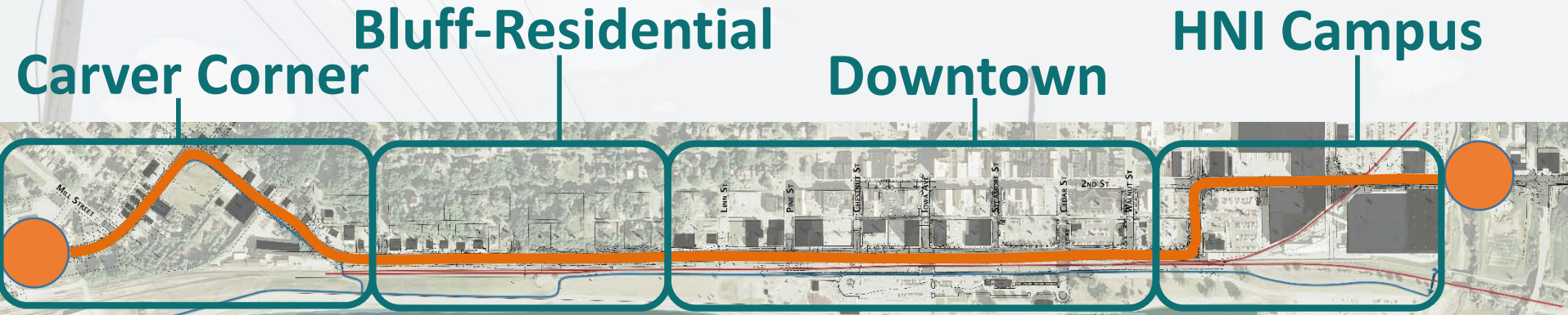

Critical Points:

- Diverse Corridor
- Poorly Connected
- Changing Right-Of-Way Widths
- **Huge Asset to the Community.....And it's time for an update.**

Progress Recap | What's been Happening?

Previous Open House

- Presented broad picture concepts
- Asked for feedback to guide the design process
- **Polling Results:**
 - 64% favored changing 2nd St. to a 2-Way
 - 61% favored a roundabout at Carver Corner
 - 67% said we should consider back-in angled parking
 - 76% favored a combination of hardscape, ornamental plantings, and trees in the medians

Progress Recap | What's been Happening?

In-Progress work:

- Finalizing corridor vertical roadway alignment
- Determining finish grade of roadway surface
- Coordinating the utility design with Muscatine Power and Water
- Coordinating Railroad design with Canadian Pacific
- Developing concept design for streetscape elements
- Developing a staging plan to minimize construction impacts

Roadway Alignment | Typical 3 Lane Section

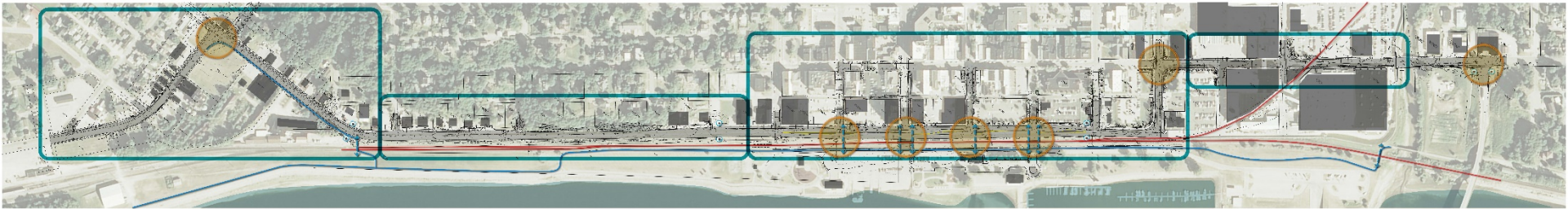

Dissecting the Corridor | By District

Carver Corner:

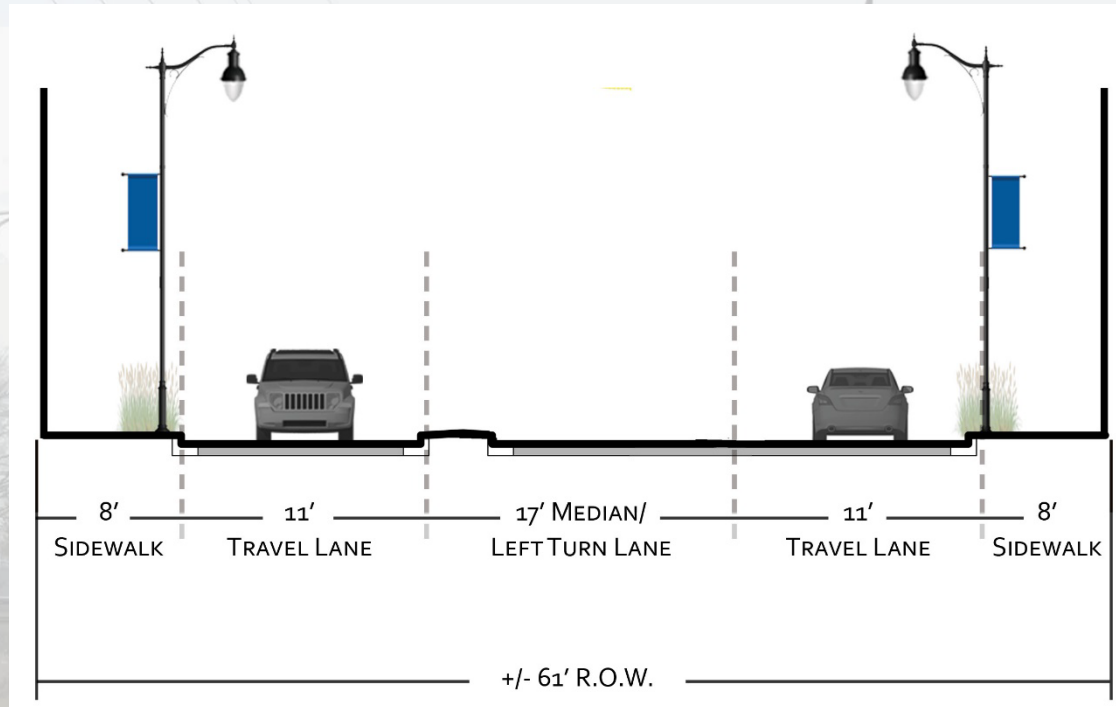

Section: 3 Lane with Median

Dissecting the Corridor | By District

Bluff District:

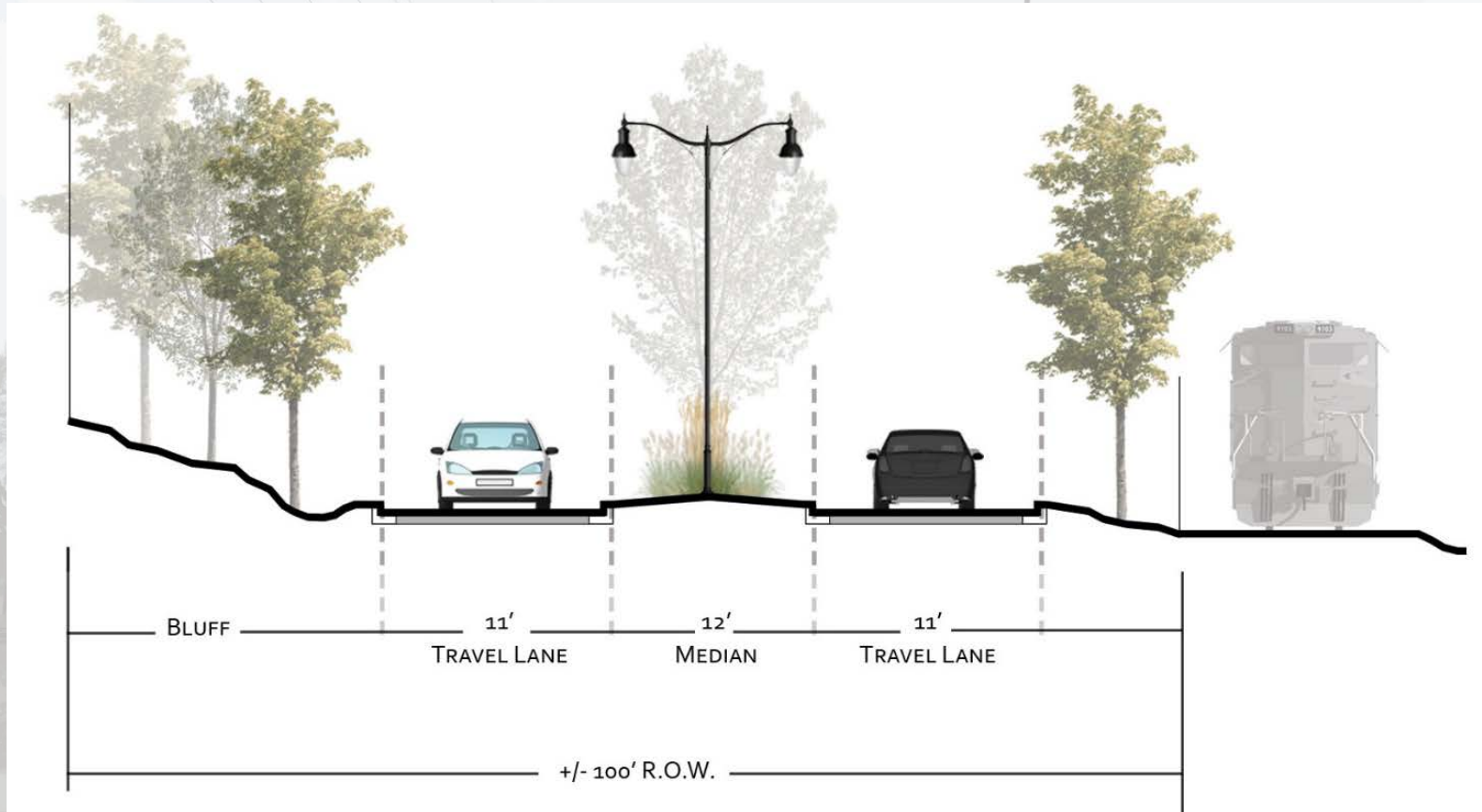

Section: 2 Lane with Median

Dissecting the Corridor | By District

Downtown District:

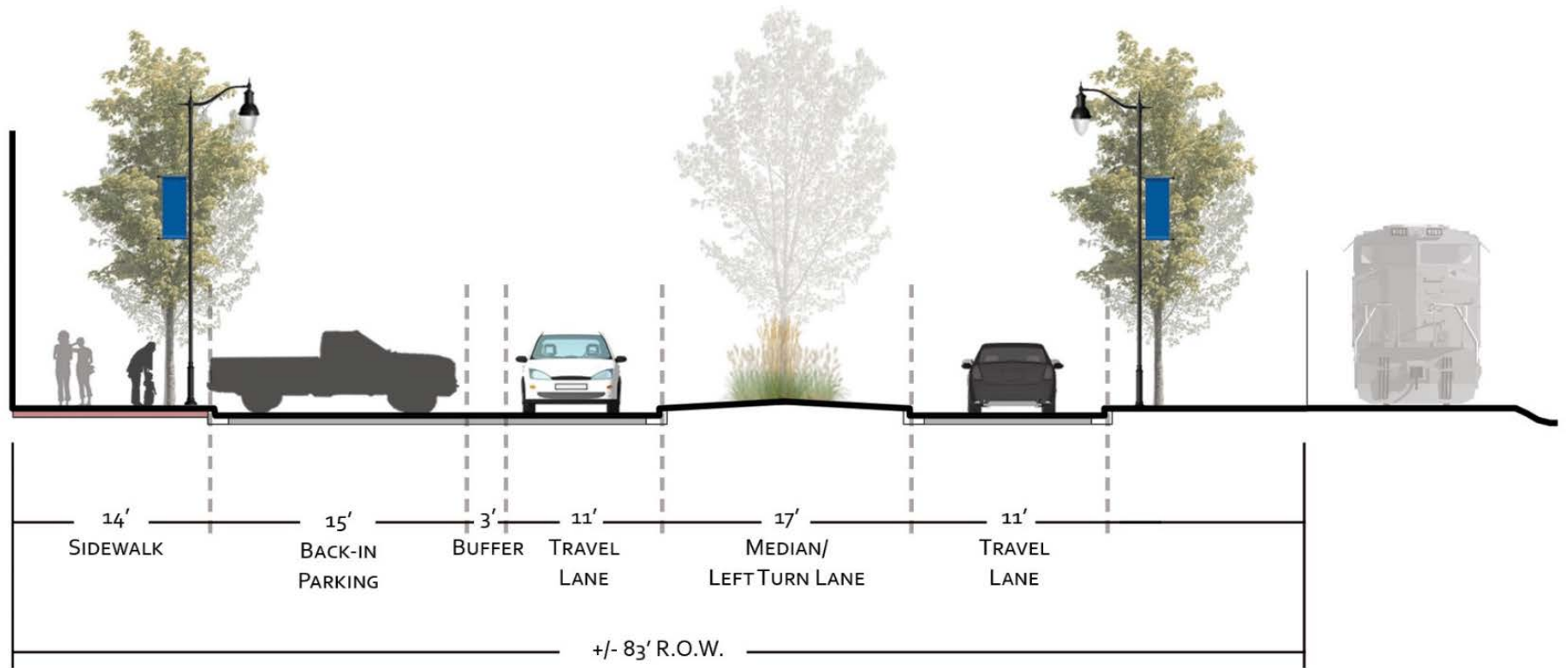

Section: 3 Lane with Median/Left Turn Lane

Dissecting the Corridor | By District

HNI Campus District:

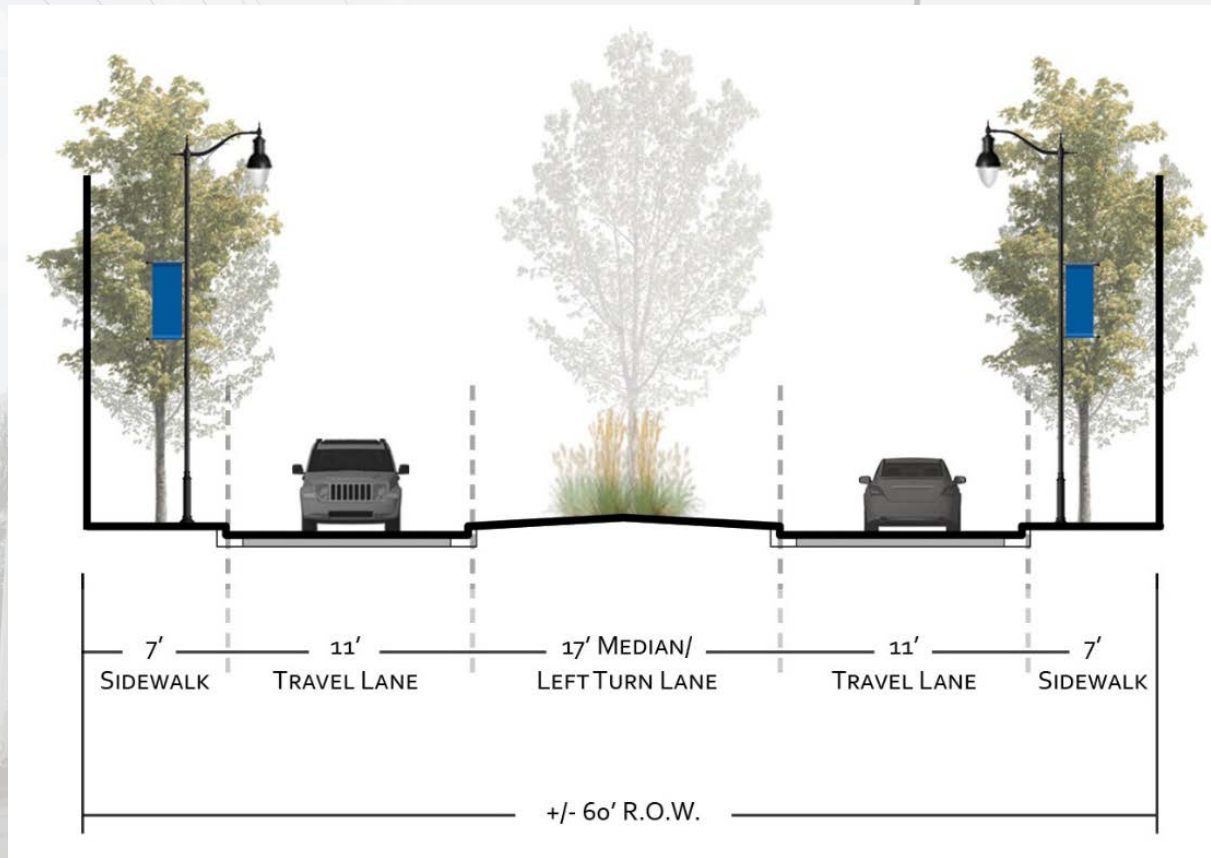

Section: 3 Lane with Median/Left Turn Lane

Intersection Design | Carver Corner Roundabout Alternative:



Intersection Design | **Carver Corner**

Roundabout Alternative:

Pros:

- Lower costs than signalized intersection
- Free flowing traffic
- Gateway to downtown

Cons:

- Different traffic flow than before
- Impacts different properties than originally planned



Intersection Design | Carver Corner

Roundabout Alternative:

If this option was feasible for implementation, would you be in favor?

A. Yes

B. No

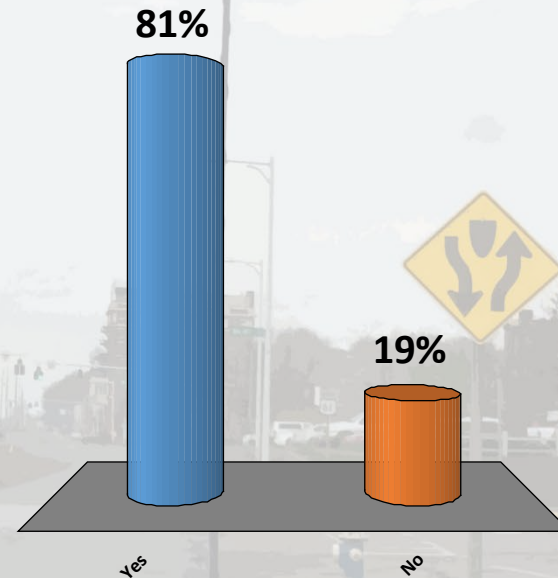

Intersection Design | Carver Corner

Roadway “Sweep” Alternative:



Intersection Design | Carver Corner

Roadway “Sweep” Alternative

Pros:

- **Traditional Design**
- **Free flowing traffic on Miss./Grandview**
- **Impacts same property initially planned**

Cons:

- **Higher Costs**
- **Less space for a “gateway entrance”**

Intersection Design | Carver Corner

Roadway “Sweep” Alternative

If this option was feasible for implementation, would you be in favor?

A. Yes

B. No

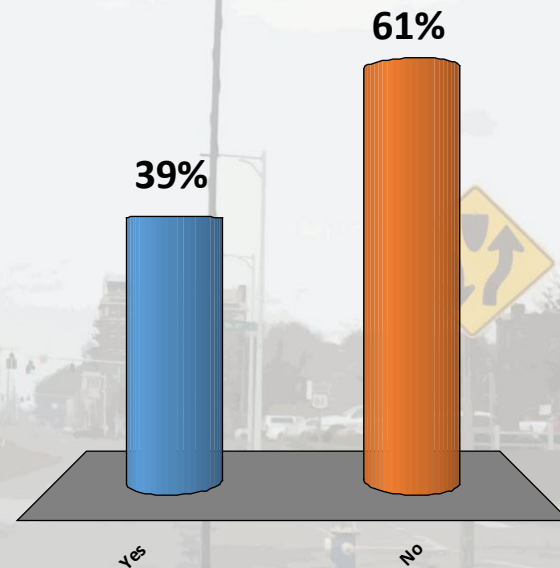

Intersection Design | 2nd & Mulberry

Roundabout Alternative:



Intersection Design | **2nd & Mulberry**

Roundabout Alternative:

Pros:

- Lower costs
- Free flowing traffic, especially during events
- Gateway to downtown
- Better truck traffic flows

Cons:

- Different traffic flow than before
- Bigger footprint
- Impacts different properties than originally planned



Intersection Design | 2nd & Mulberry

Roundabout Alternative:

If this option was feasible for implementation, would you be in favor?

A. Yes

B. No

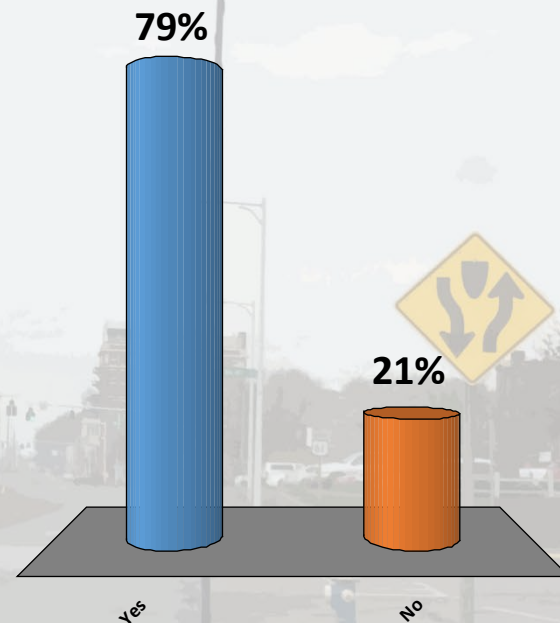

Intersection Design | 2nd & Mulberry

Traditional Signalized Intersection:

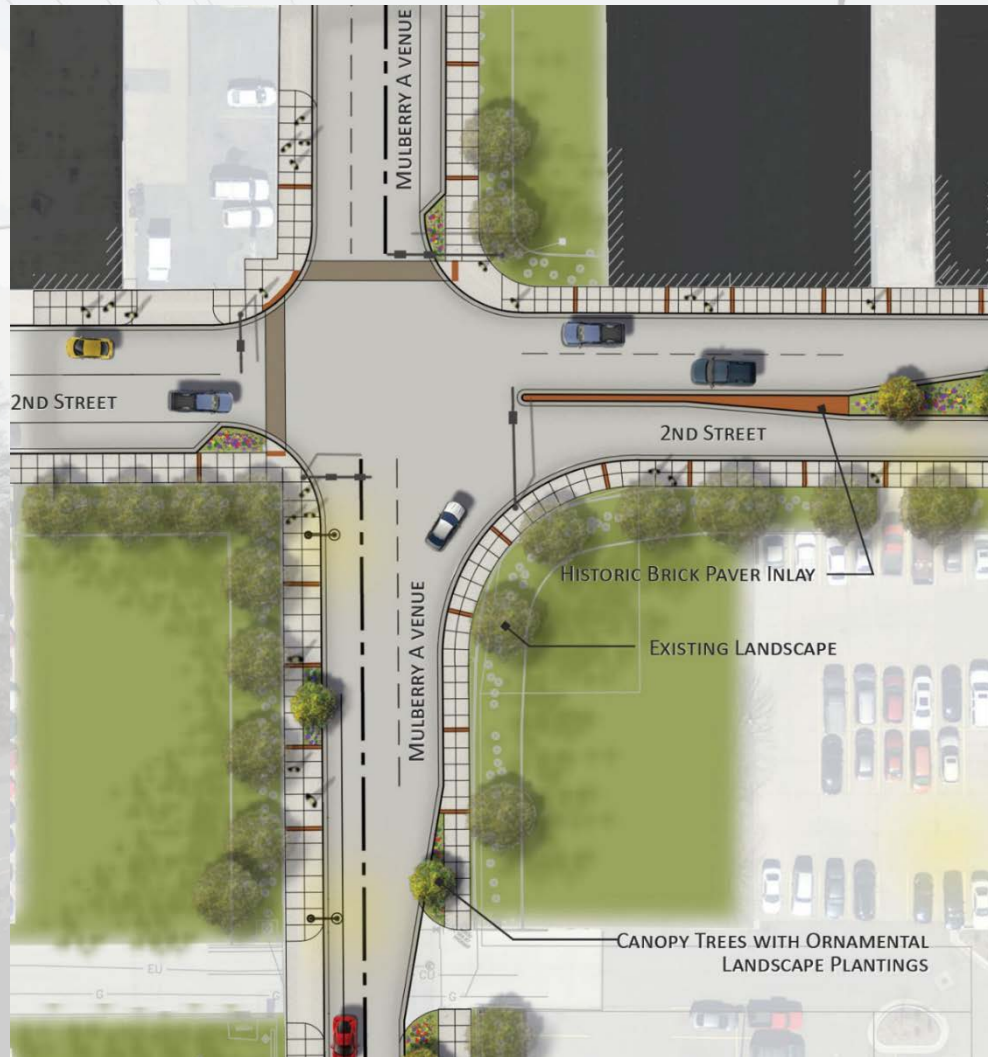

Intersection Design | 2nd & Mulberry

Traditional Signalized Intersection:

Pros:

- Traditional design
- Less footprint
- Impacts same properties that were initially planned

Cons:

- Higher costs
- Less area for downtown gateway
- More traffic congestion during events
- Less truck movement opportunities



Intersection Design | 2nd & Mulberry

Traditional Signalized Intersection:

If this option was feasible for implementation, would you be in favor?

A. Yes

B. No

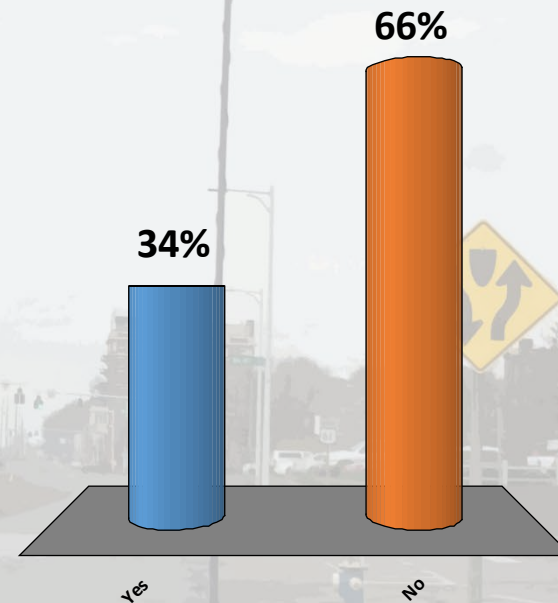

Intersection Design | Iowa Ave.

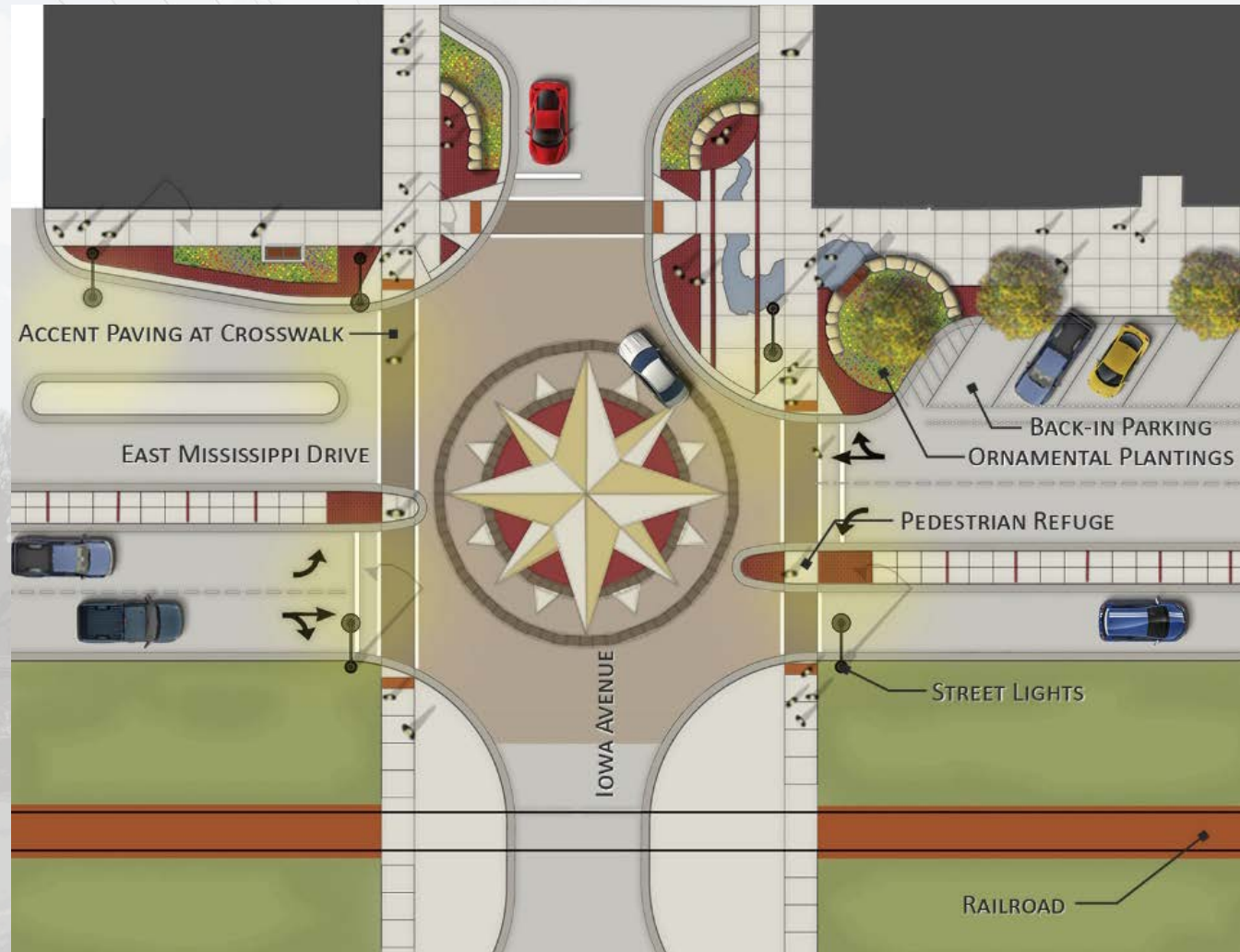

Intersection Design | Detailed Design



Intersection Design | Sycamore St.

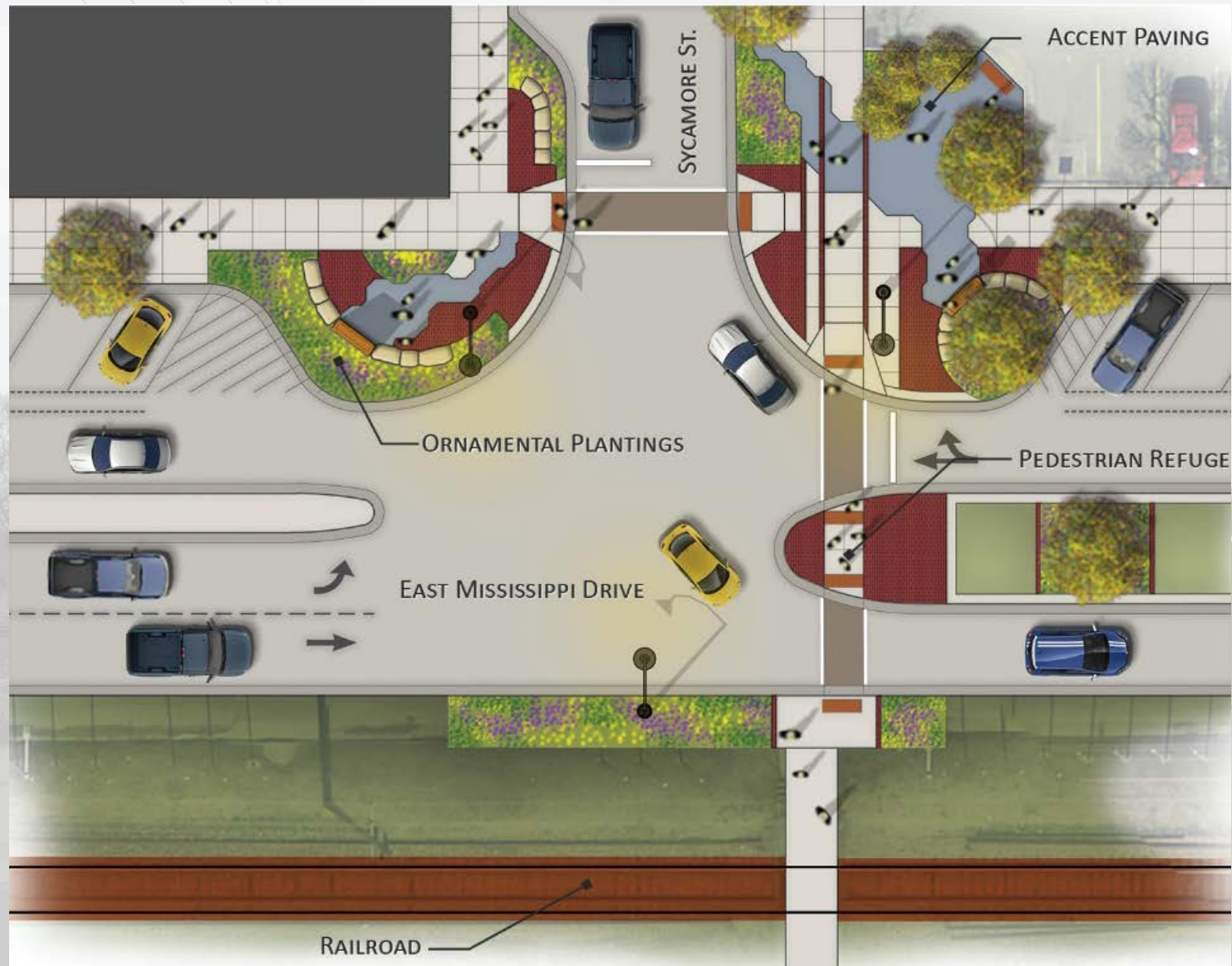

Intersection Design | Detailed Design

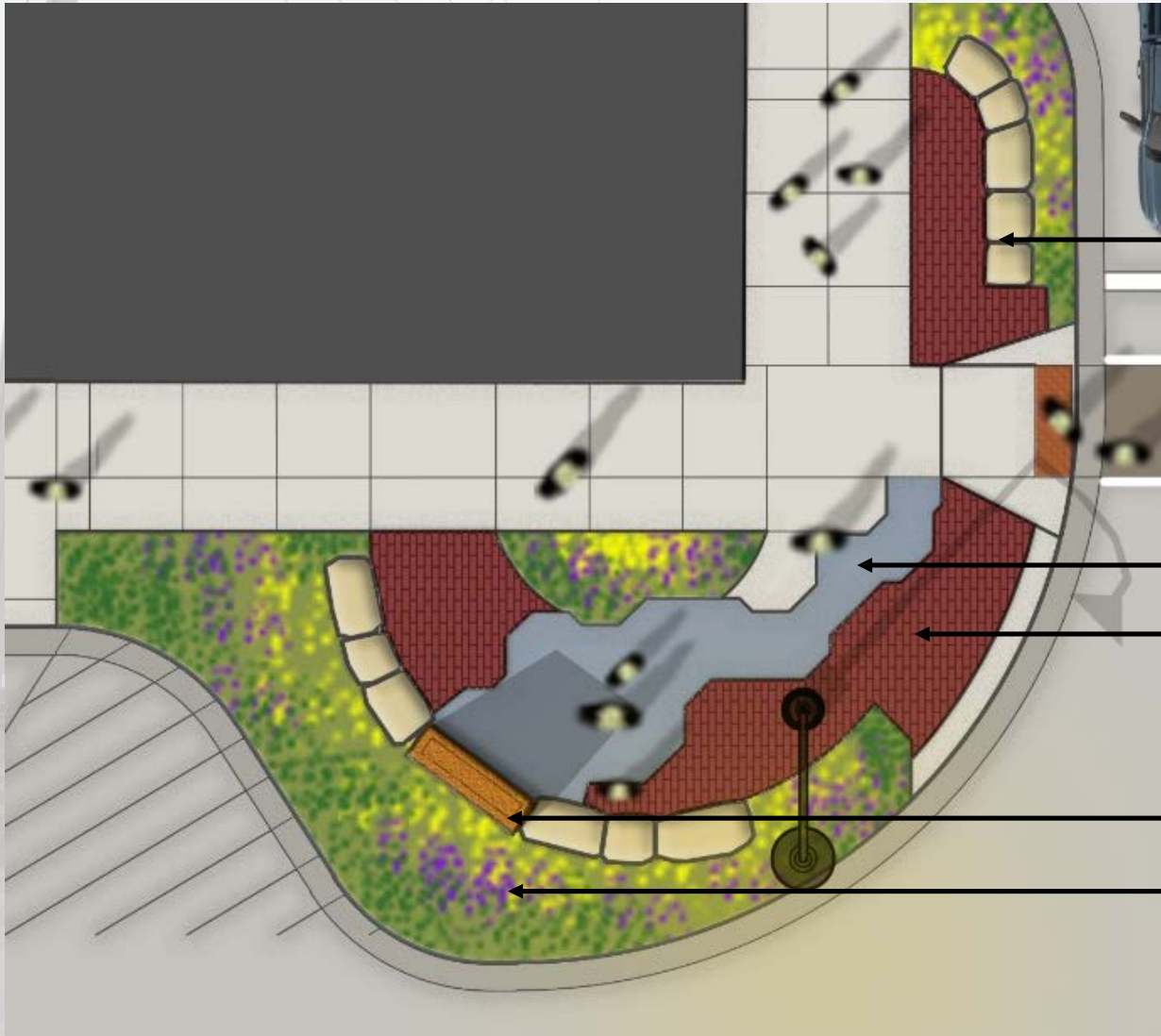

Limestone Outcroppings

River Pattern paving Inlay

Decorative Pavers

Information Kiosk

Ornamental Planting

Intersection Design | Detailed Design



Intersection Design | Detailed Design

Are you in favor of incorporating a “river pattern” into the sidewalk paving design?

A. Yes

B. No

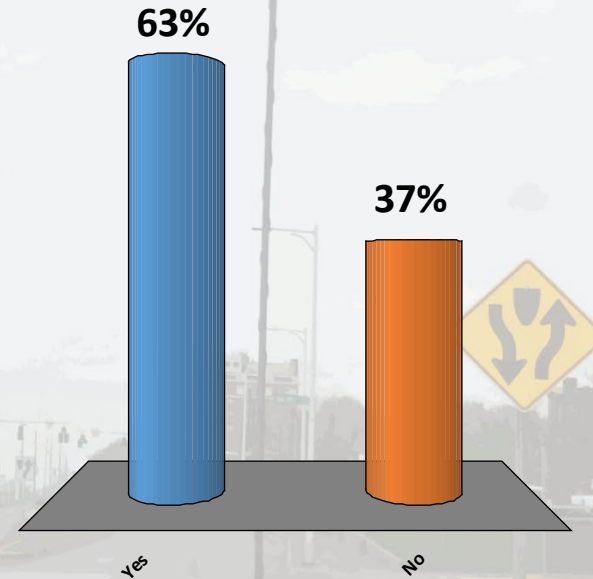

Intersection Design | Detailed Design

Are you in favor of incorporating a design element into the intersection paving pattern, thinking specifically about Iowa and/or Sycamore?

A. Yes

B. No

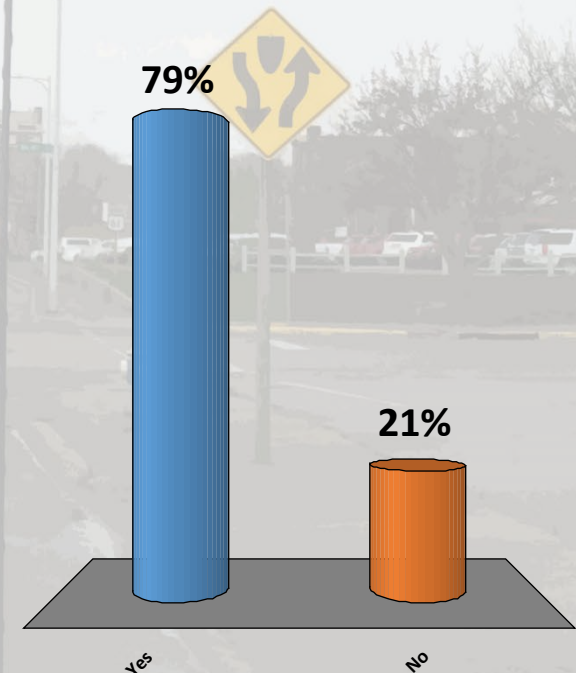

Intersection Design | Detailed Design

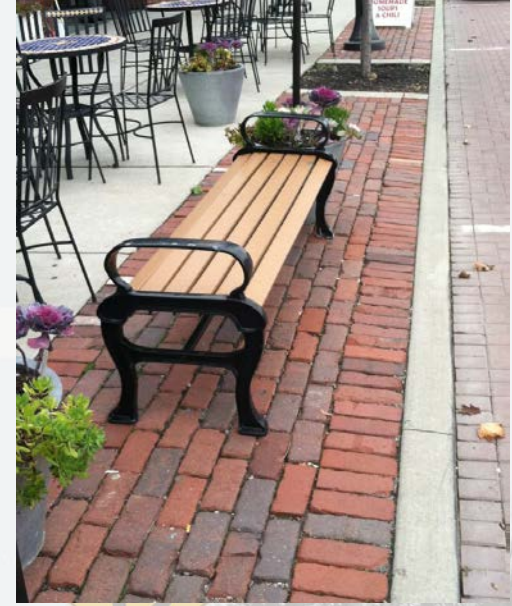

Intersection Design | Detailed Design

Pedestrian Refuge:

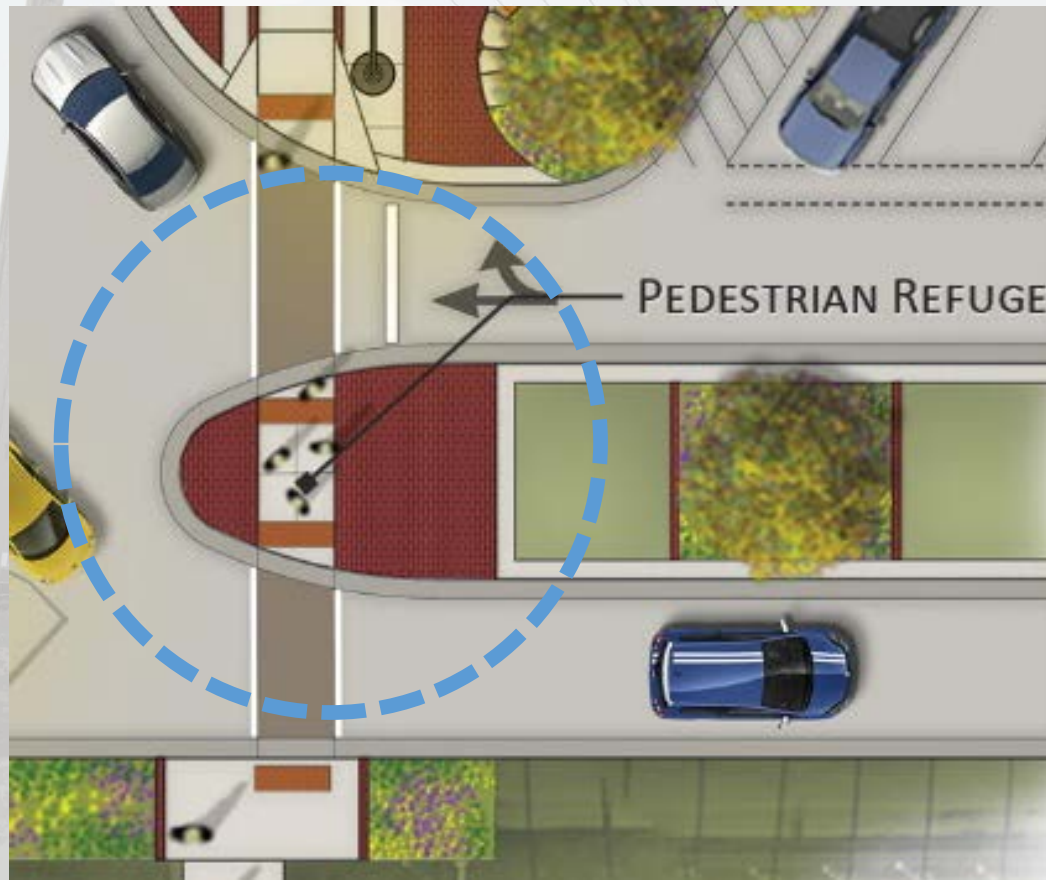

Intersection Design | Detailed Design

Accessible On-Street Parking:

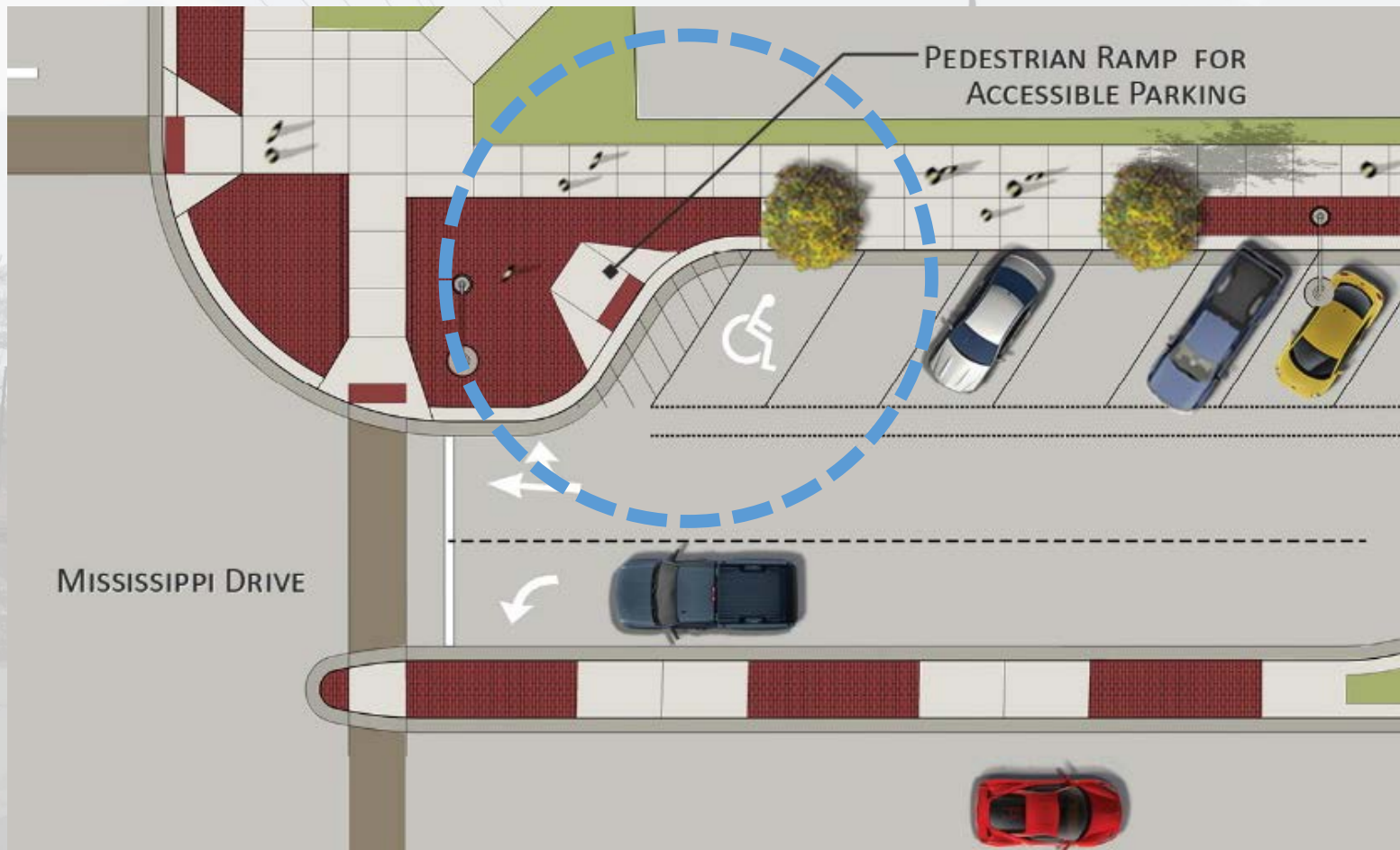

Streetscape Character | Materials/Finishes

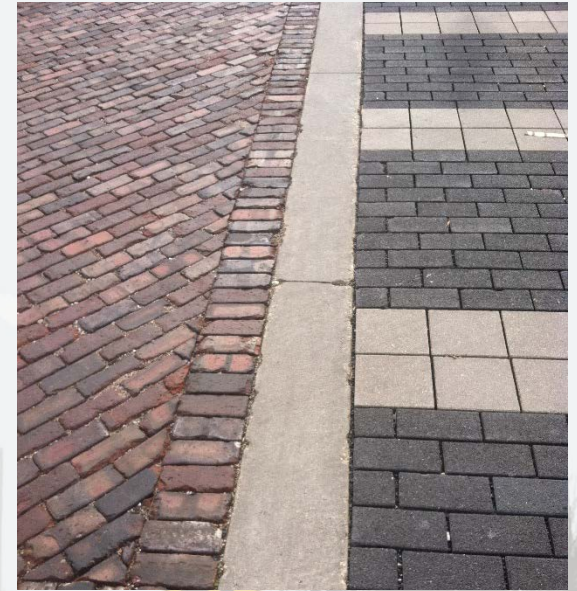

Median Design | The Right Amount of Planting



Median Design | The Right Amount of Planting



Median Design | Levels of Landscaping

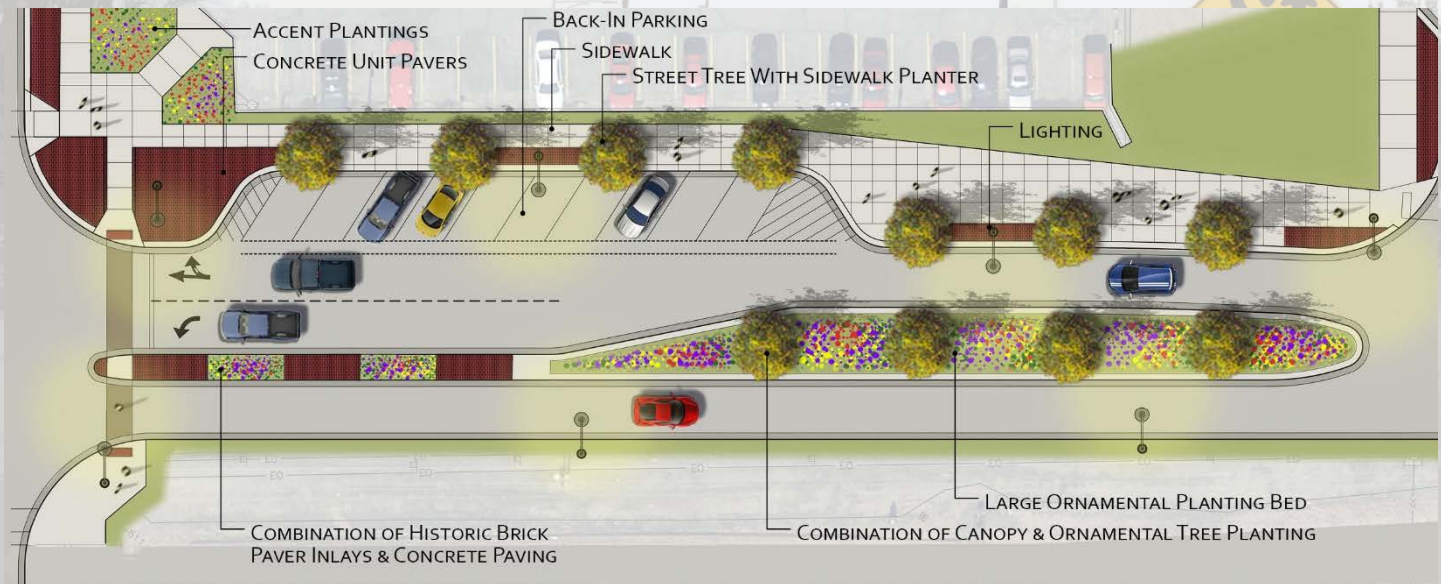
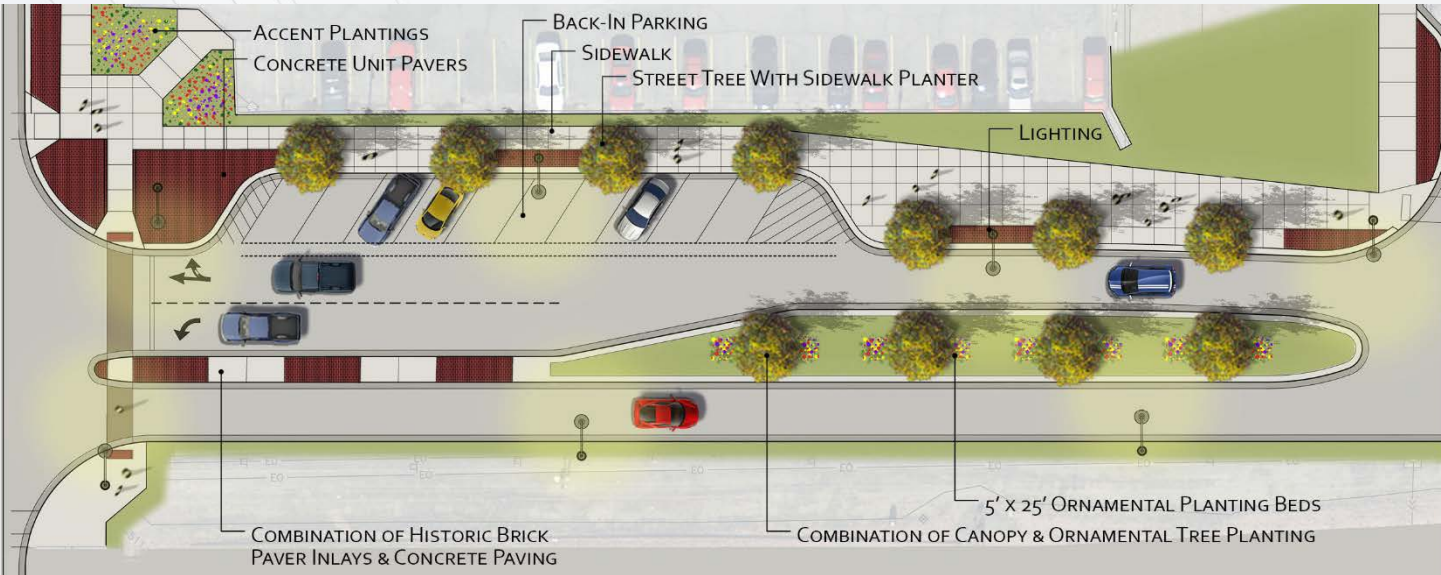

Median Design | The Right Amount of Planting

Do you prefer:

- A. Less plantings more hardscape?**
- B. More Plantings less hardscape?**
- C. Not sure?**

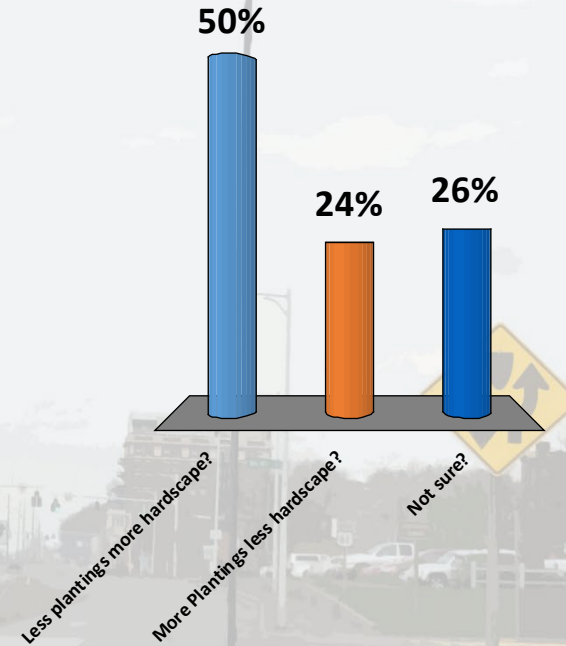

Median Design | The Right Amount of Planting

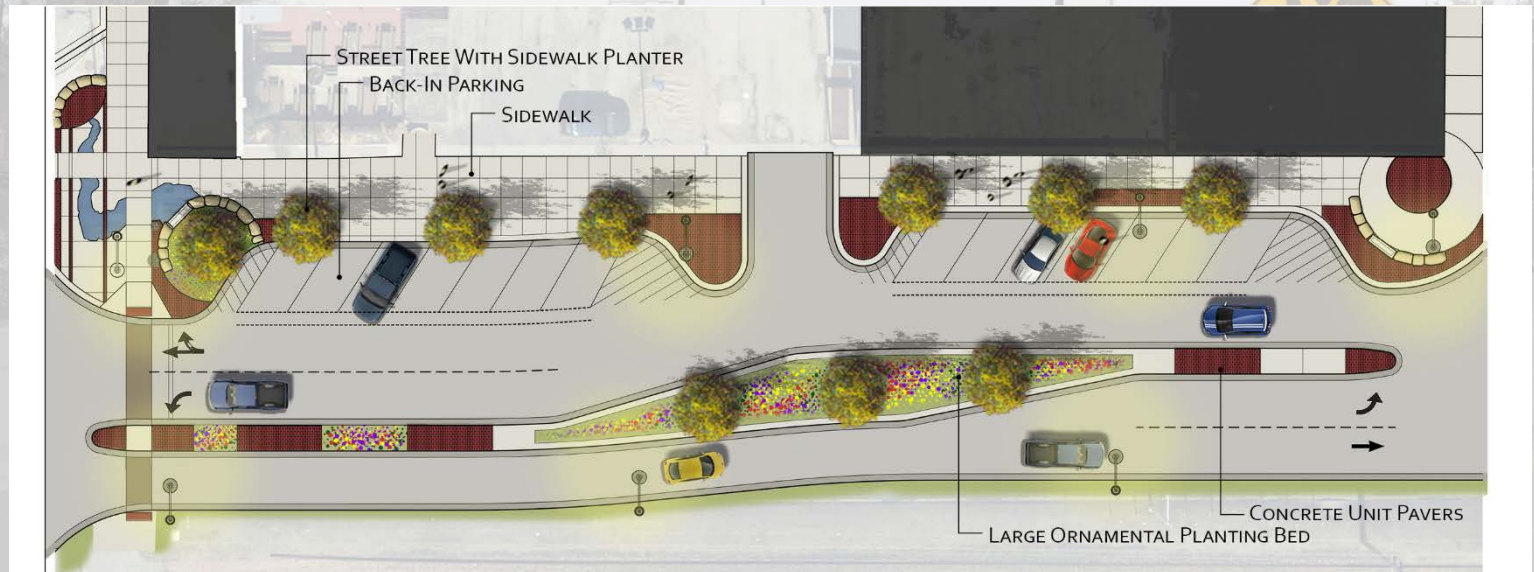

Median Design | The Right Amount of Planting

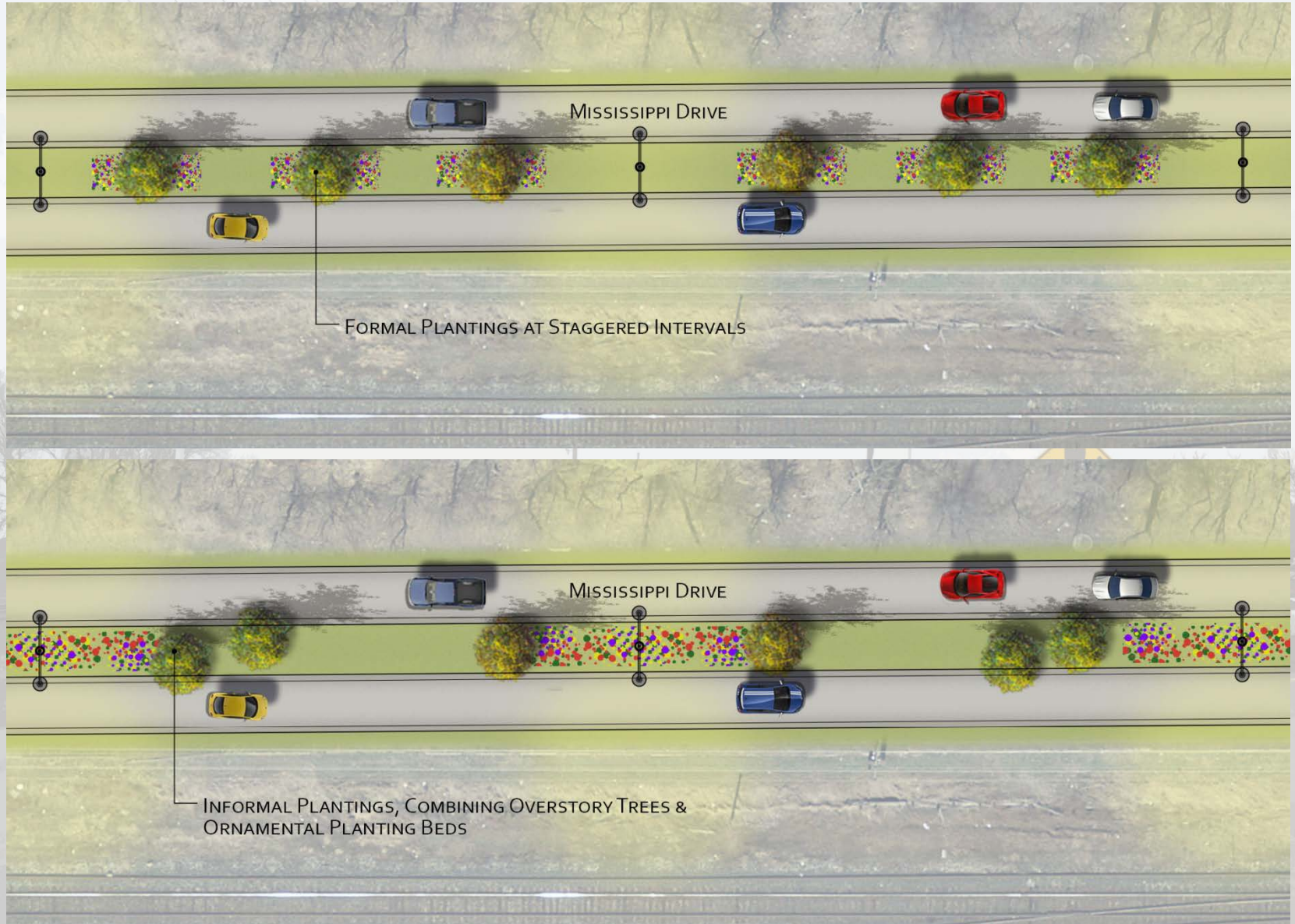

Median Design | The Right Amount of Planting

In the Bluff Area, do you prefer:

- A. More formal Plantings
- B. Less formal landscape
- C. Not sure

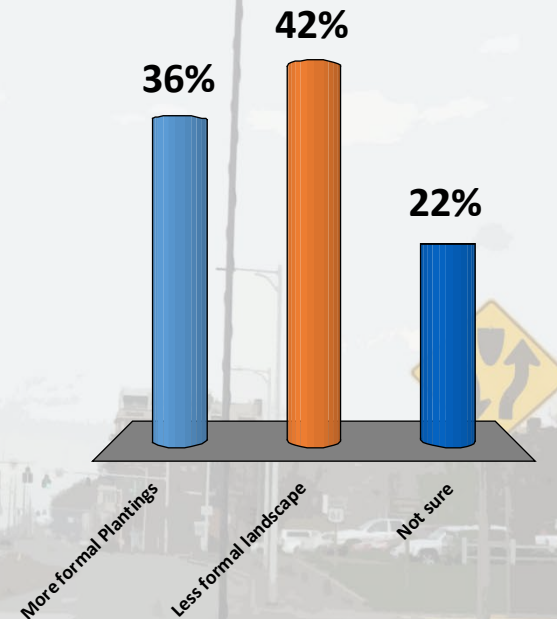

Streetscape Character | Lighting

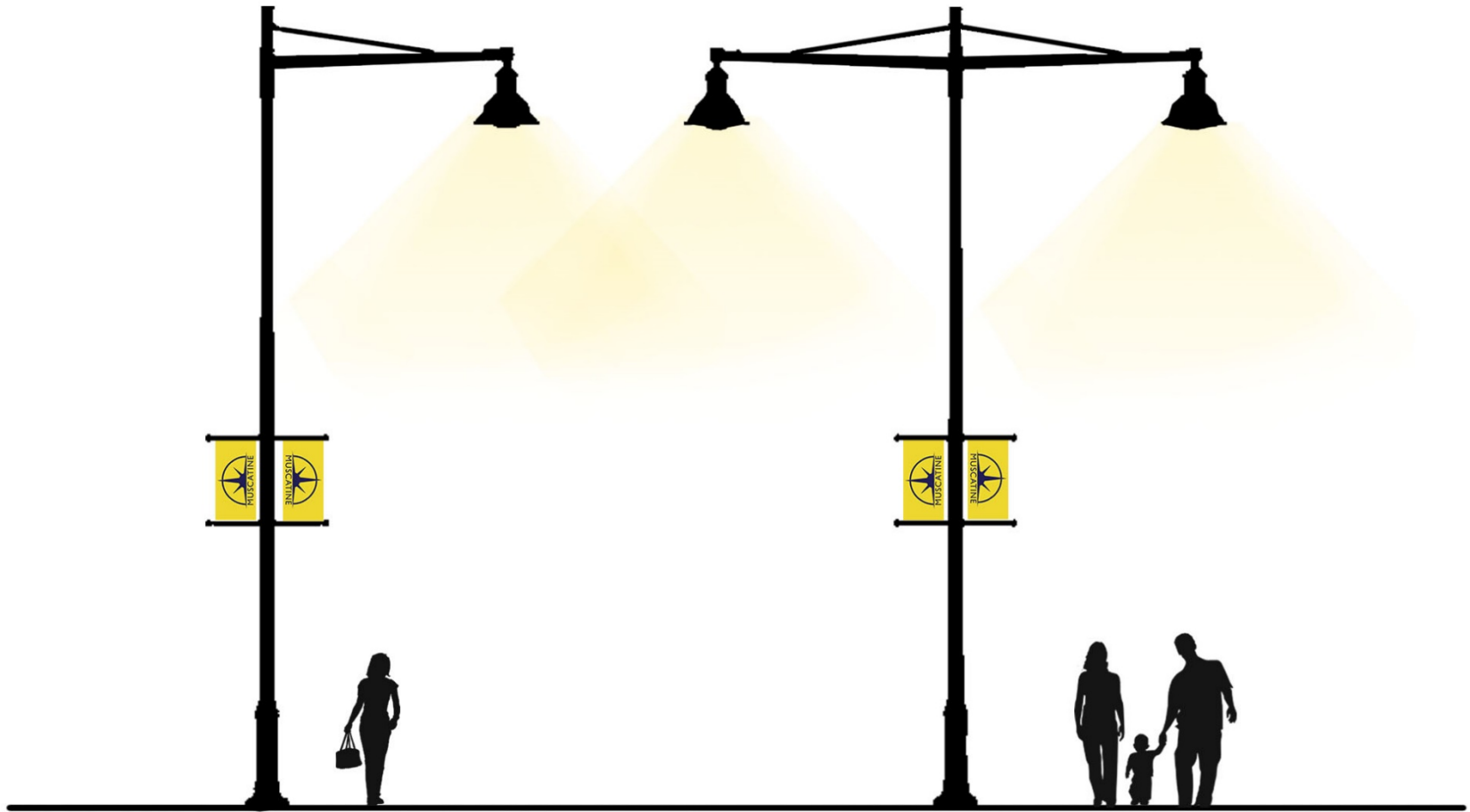

Streetscape Character | Lighting

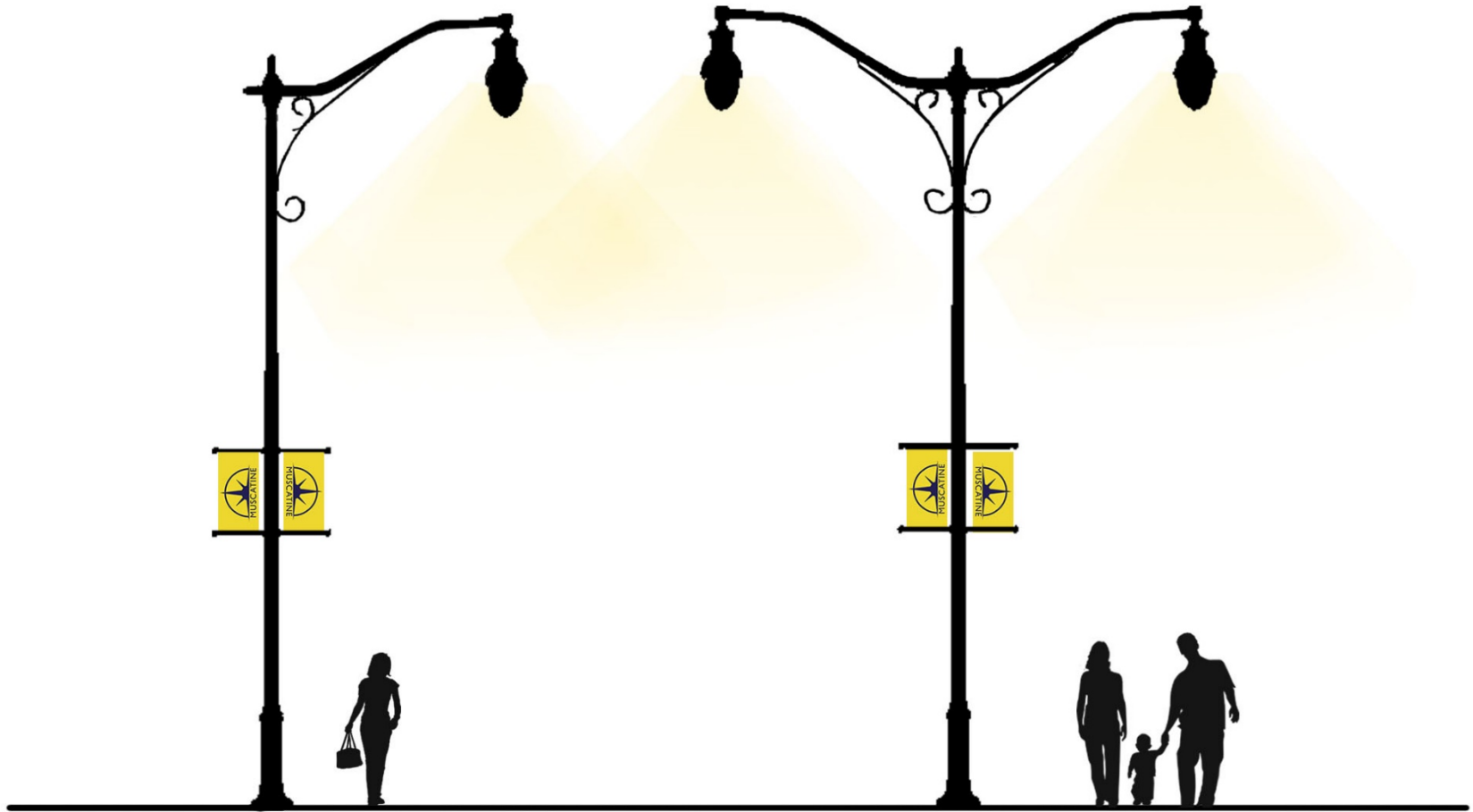

Streetscape Character | Lighting

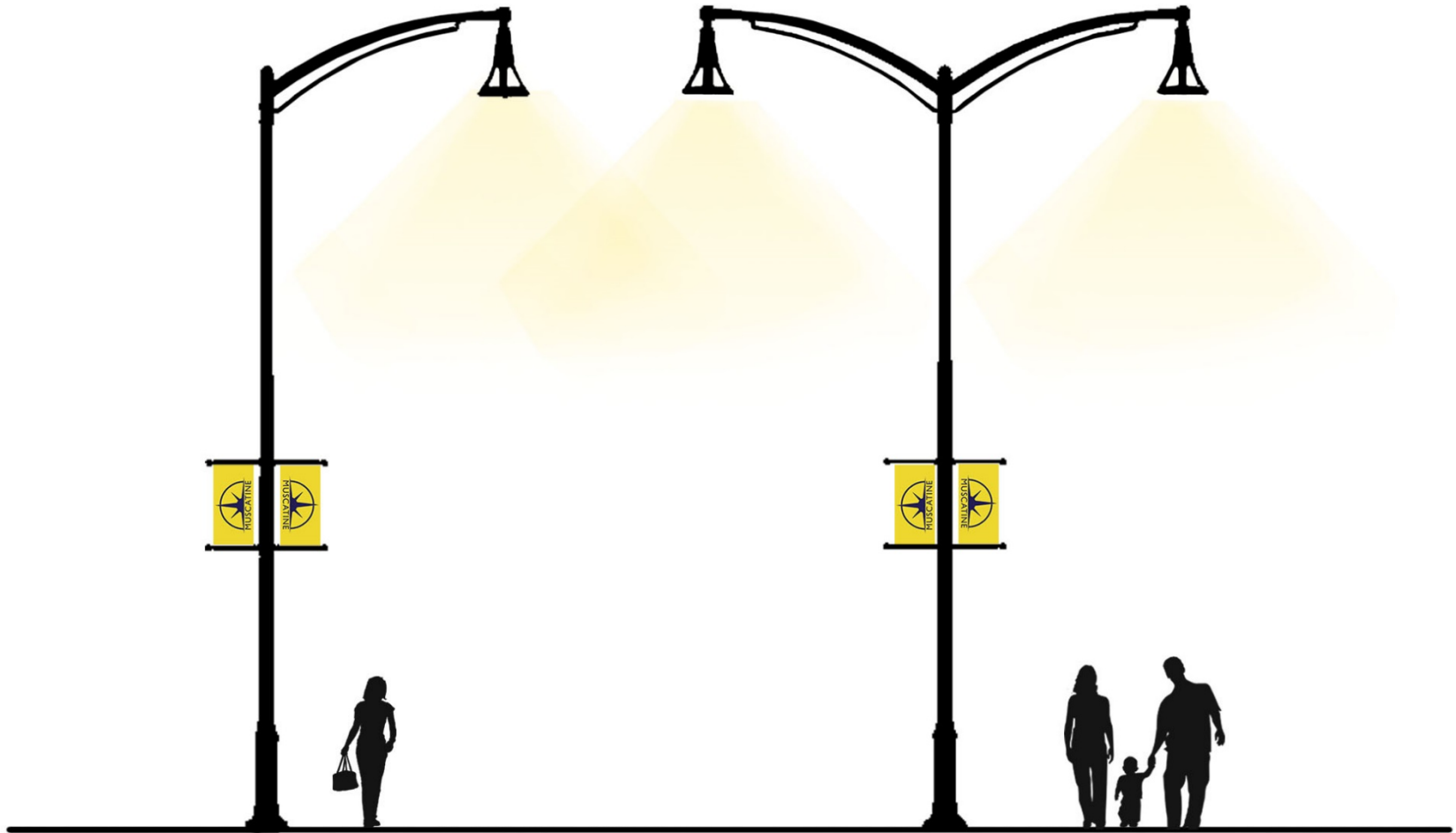

Streetscape Character | Lighting

Do you prefer:

- A. Straight Arm lighting (timeless)**
- B. Bent Arm Lighting (historic)**
- C. Arced Arm Lighting (contemporary)**

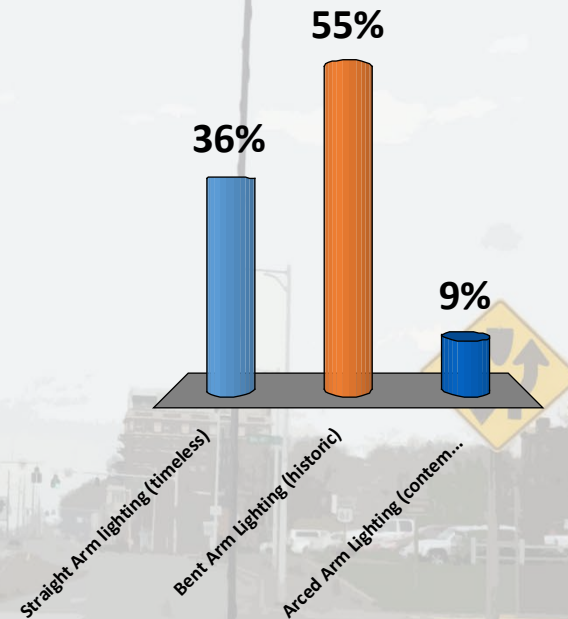

...What's Next?

To Do List:

- Develop refined concepts based on feedback from tonight
- Coordinate with other agencies, MPW, and CP Railway
- Present concepts to Community and City Council
- Develop Final Plans and Specifications
- Bidding and Construction

**...Thanks
& Good
Night!**

